

## FINCHLEY ROAD LONDON, NW3 7AA

**£870,000**  
**SHARE OF FREEHOLD**

Taylor Hawkins is delighted to bring to market this stunning newly built 3-bedroom apartment, perfectly situated in the heart of Hampstead on the prestigious Finchley Road. Key Features: Three Luxurious Bedrooms: This beautiful property boasts three spacious bedrooms, each designed with high Victorian-style ceilings that enhance the sense of space and elegance. The rooms are filled with natural light, creating a bright and airy ambiance throughout. Private Entrance: Enjoy the privacy and exclusivity of your own private entrance, a rare find in such a prime location. State-of-the-Art En-Suites: Two of the three bedrooms come with meticulously designed en-suite bathrooms. These feature cutting-edge fixtures and finishes, blending modern luxury with timeless Victorian charm.

Architectural Excellence: As you enter the property, you'll be struck by the seamless fusion of modern and Victorian design elements. The contemporary interiors are complemented by period features, offering a unique and sophisticated living experience.



**TAYLOR HAWKINS**  
Estate Agents  
0208 958 2222 / [Taylor-hawkins.co.uk](http://Taylor-hawkins.co.uk)

### Finchley Road, London, NW3

Approximate Area = 1155 sq ft / 107.3 sq m

For identification only - Not to scale

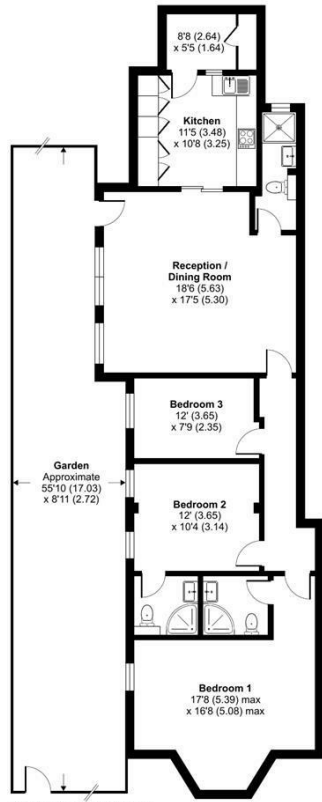

Floor plan produced in accordance with RICS Property Measurement Standards incorporating International Property Measurement Standards (IPMS2 Residential). © ricscom 2024. Produced for Taylor Hawkins. REF: 1169474

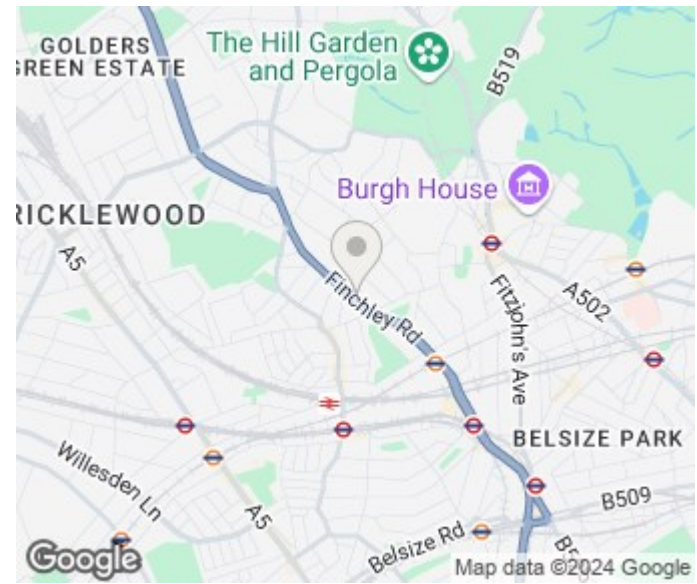

Energy Efficiency Rating		Current	Potential
Very energy efficient - lower running costs			
(92 plus) A			
(81-91) B		77	77
(69-80) C			
(55-68) D			
(39-54) E			
(21-38) F			
(1-20) G			
Not energy efficient - higher running costs			
<b>England &amp; Wales</b>		EU Directive 2002/91/EC	

Agents Note: Whilst every care has been taken to prepare these particulars, they are for guidance purposes only. All measurements are approximate and are for general guidance purposes only and whilst every care has been taken to ensure their accuracy, they should not be relied upon and potential buyers/tenants are advised to recheck the measurements

Edgware Sales  
58 Edgware Way  
Edgware  
Middlesex  
HA8 8DJ

020 8958 2222  
property@taylorhawkins.co.uk  
<https://taylorhawkins.co.uk/>



**TAYLOR HAWKINS**  
Estate Agents  
0208 958 2222 / [Taylorhawkins.co.uk](https://taylorhawkins.co.uk)